

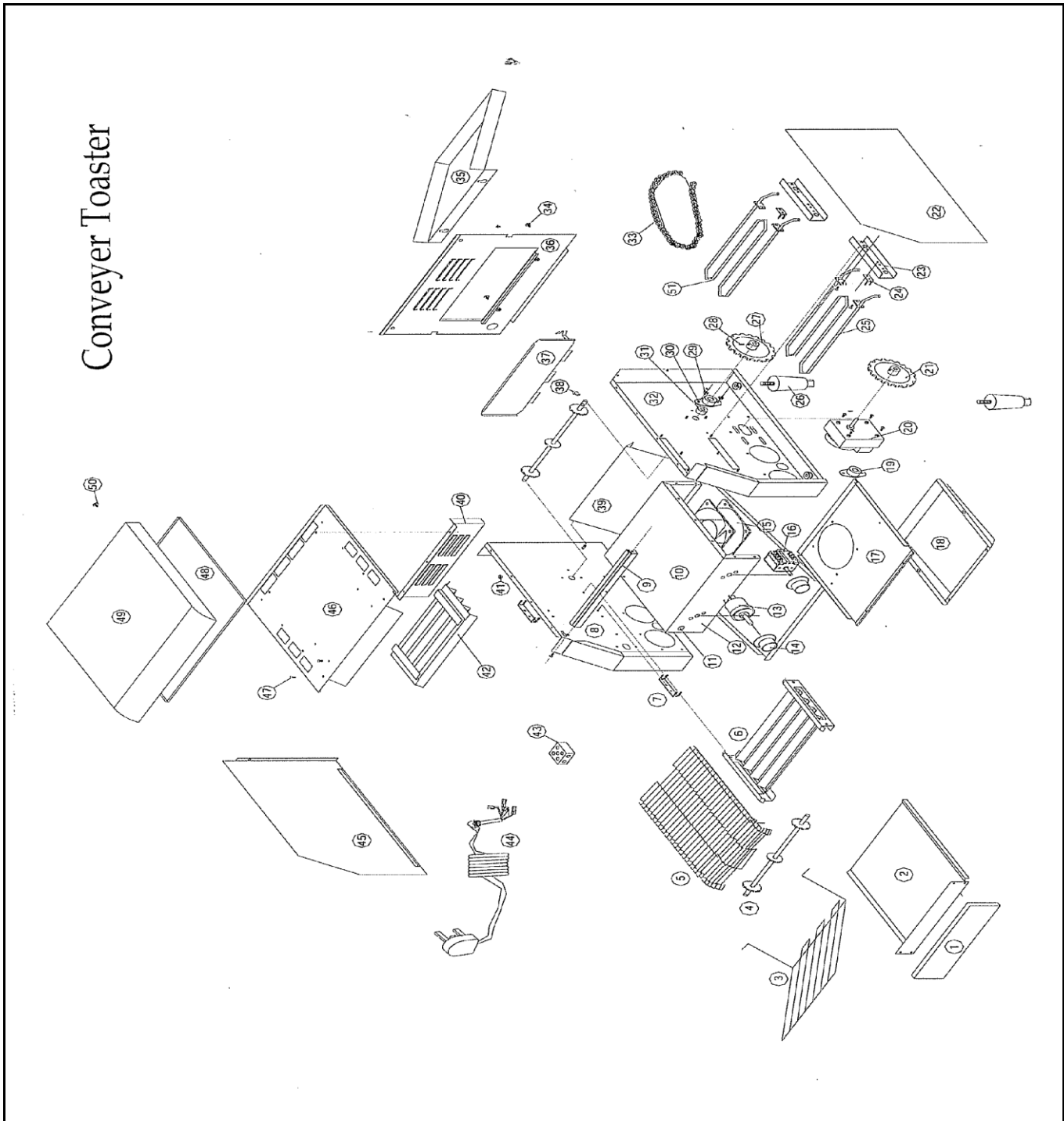

Drawing

 <p>Hendi B.V. Steenoven 21 3911 TX Rhenen The Netherlands</p>	Batch #	Appliance part#
	0000000	261309
	Description	
	Toaster	

Date	09-05-2011	Revision #	Revision version
Revision	First bill of materials (BOM)		



Bill of materials (BOM)

 Hendi B.V. Steenoven 21 3911 TX Rhenen The Netherlands	Batch #	Appliance part#
	0000000	261309
	Description	
Toaster		

Date	09-05-2011	Revision #	Revision version
Revision	First bill of materials (BOM)		

Item	Description	Part#	Quantity	Remark	Picture
1	Front panel crumb tray	nss	1	Available as 926253	
2	Crumb tray	926253	1	Incl item 1	
3	Grid	n/a	1		
4	Transmission shaft	n/a	2		
5	Conveyor	n/a	1		
6	Cover lower element	n/a	1		
7	Support conveyor	n/a	2		
8	Panel left	n/a	1		
9	Support front	n/a	1		
10	Base plate	n/a	1		
11	Indicator light	926260	1		
12	Display sticker	n/a	1		
13	Rheostat	926277	1		
14	Knob	926284	1		
15	Fan	926291	1		
16	Switch	926307	1		
17	Base panel	n/a	1		
18	Bottom cover	n/a	1		
19	Bearing transmission shaft	n/a	2		
20	Motor	926314	1		
21	Gear motor	n/a	1		
22	Cover right	n/a	1		
23	Retainer element	n/a	2		
24	Element support right	n/a	2		
25	Lower element	926321	1		
26	Foot adjustable	926338	4		
27	Gear transmission shaft	n/a	1		
28	Lock pin	n/a	2		
29	Nut	n/a	8		
30	Bearing driven transmission shaft	n/a	2		
31	Spacer	n/a	1		
32	Panel right	n/a	1		
33	Chain	n/a	1		
34	Screw	926345	2	Sold per 2 pcs	
35	Back tray	n/a	1		
36	Back cover	n/a	1		
37	Back plate	n/a	1		
38	Clip	n/a	1		
39	Slide tray	n/a	1		
40	Back vent plate	n/a	1		
41	Plate screws	n/a	4		
42	Cover upper element	n/a	1		
43	Terminal	n/a	1		
44	Powercord (H05RN-F 3Gx1.5mm)	930045	1		
45	Cover left	n/a	1		
46	Top panel	n/a	1		
47	Screw	n/a	12		
48	Sealing top cover	n/a	1		
49	Top cover	n/a	1		
50	Screw	n/a	2		
51	Upper element	926352	1		
*	cordinlet with retention	912201	1	Not shown on expl view	

n/a -> not available

nss -> not sold separately

Circuit diagram

 <p>Hendi B.V. Steenoven 21 3911 TX Rhenen The Netherlands</p>	Batch #	Appliance part#
	0000000	261309
	Description	
	Conveyor Toaster	

Date	09-05-2011	Revision #	Revision version
Revision	First bill of materials (BOM)		

